

SOUTHERN FORCE MAIN FROM DEE CEE COURT TO WHITE HOUSE SEWER PLANT FOR THE CITY OF WHITE HOUSE WHITE HOUSE, TENNESSEE (ROBERTSON COUNTY) MARCH 2022

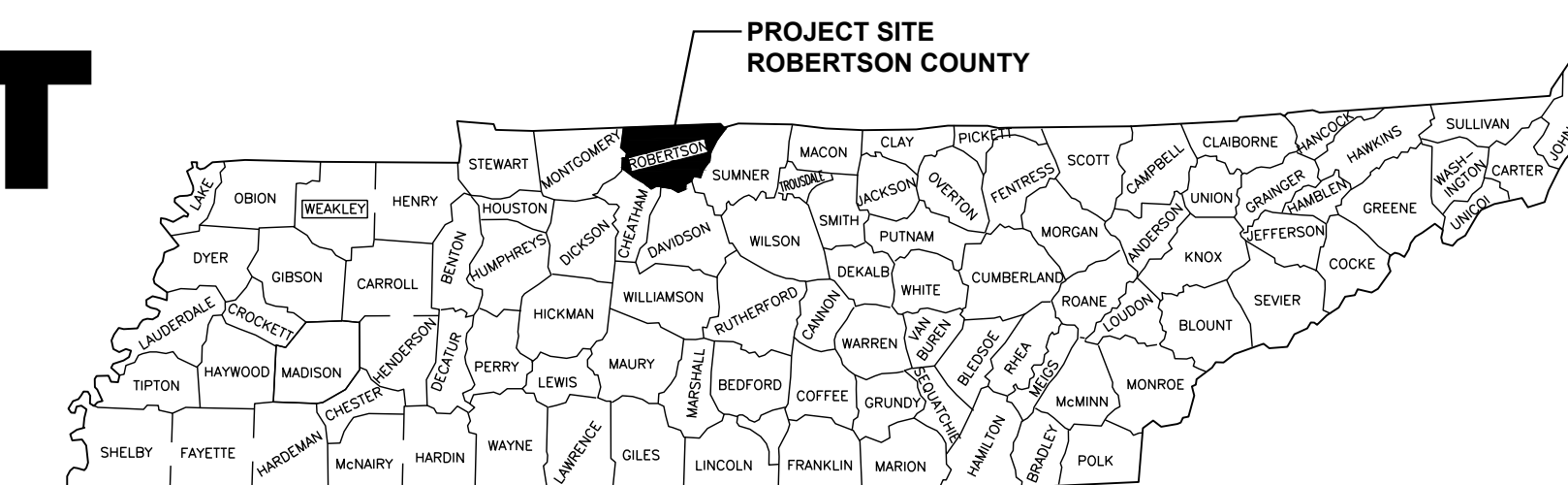

CONTRACTOR'S NOTES:

THE CONTRACTORS WORK TO BE PERFORMED UNDER THIS PROJECT WILL CONSIST OF FURNISHING ALL EQUIPMENT, LABOR, TOOLS AND SUPERVISION NECESSARY FOR THE CONSTRUCTION OF THE PROPOSED WORK AND ALL OTHER RELATED WORK AS LISTED IN THE PLANS AND SPECIFICATIONS.

THE CONTRACTOR SHALL VERIFY ALL DIMENSIONS, UTILITY LOCATIONS, ELEVATIONS, EXISTING INVERTS PRIOR TO CONSTRUCTION, IF A DISCREPANCY IS FOUND, THE CONTRACTOR SHALL NOTIFY THE ENGINEER OR REPRESENTATIVE IMMEDIATELY.

ALL WORK SHALL COMPLY WITH ALL LOCAL, STATE AND FEDERAL CODES AND LAWS. ALL NECESSARY LICENSES AND PERMITS SHALL BE THE CONTRACTOR'S RESPONSIBILITY.

UTILITY OWNERS
WATER SERVICE
WHITE HOUSE UTILITY DISTRICT P.O. BOX 608 WHITE HOUSE, TN 37188 615-672-1033
SANITARY SEWER SERVICE
CITY WHITE HOUSE 725 INDUSTRIAL DRIVE WHITE HOUSE, TN 37188 615-672-3654
NATURAL GAS UTILITY SERVICE
PIEDMONT GAS COMPANY 83 CENTURY BLVD. NASHVILLE, TN 37214 615-734-1760
ELECTRIC SERVICE
CUMBERLAND ELECTRIC MEMBERSHIP CORPORATION P.O. BOX 3300 OR 1940 MADISON STREET CLARKSVILLE, TN 37043 931-645-2481
CABLE/TELEPHONE SERVICE
COMCAST 660 MAIN STREAM DRIVE NASHVILLE, TN 37228 615-244-7462
AT&T RM 23C180 333 COMMERCE STREET NASHVILLE, TN 37201-1800 615-214-4841

END STA. 47+11±

BEGIN STA. 0+00

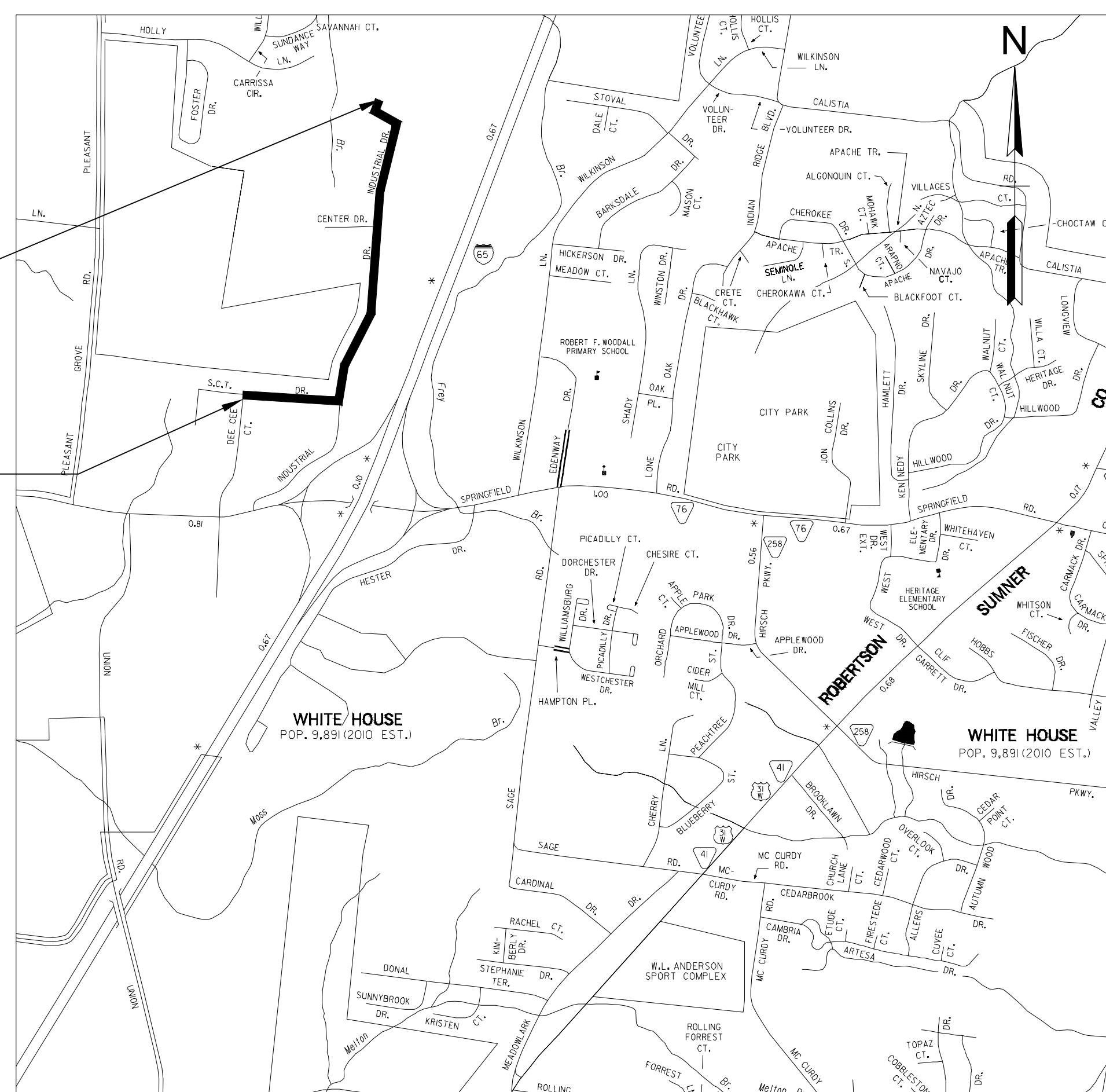

LOCATION MAP

INDEX OF DRAWINGS

SHEET	DESCRIPTION
G-001	TITLE SHEET
G-002	GENERAL NOTES
C-101	LINE "FM-3" STA. 0+00 TO STA. 12+00
C-102	LINE "FM-3" STA. 12+00 TO STA. 24+00
C-103	LINE "FM-3" STA. 24+00 TO STA. 36+00
C-104	LINE "FM-3" STA. 36+00 TO E.O.L.
C-501	DETAILS



IT IS THE CONTRACTOR'S RESPONSIBILITY TO CONTACT UTILITY COMPANIES PRIOR TO ANY CONSTRUCTION. THE LOCATION OF UTILITIES SHOWN ON THESE PLANS ARE APPROXIMATE AND POSSIBLY INCOMPLETE, THEREFORE CERTIFICATION TO THE LOCATION OF ALL UNDERGROUND UTILITIES IS WITHHELD.

LEGEND - EXISTING

TELEPHONE, ELECTRIC OR CABLE PEDESTAL	
SIGN	
LIGHT POLE	
UTILITY POLE	
GUY WIRE AND ANCHOR	
SEWER MANHOLE	
SEWER CLEAN OUT	
CURB INLET	
CATCH BASIN	
WATER METER	
FIRE HYDRANT	
WATER VALVE	
GAS METER	
GAS VALVE	
ELECTRIC JUNCTION BOX	
BENCH MARK	
IRON ROD SET	
IRON ROD FOUND	
CONCRETE MONUMENT	
FINISHED FLOOR ELEVATION	
MAILBOX	
CULVERT	
FENCE	
GUARDRAIL	
WATER LINE	
SEWER LINE	
FORCE MAIN	
GAS LINE	
UNDERGROUND ELECTRIC	
OVERHEAD ELECTRIC	
UNDERGROUND FIBER OPTIC CABLE	
UNDERGROUND TELEPHONE CABLE	
STREAM LINE	
DITCH LINE	
TREE	
WOODS LINE	
SHRUBS OR BUSHES	
CONTOUR LINE	
PROPERTY LINE	
RIGHT-OF-WAY	

LEGEND - PROPOSED

FORCE MAIN	
GATE VALVE	
AIR / VACUUM RELEASE VALVE	

GENERAL NOTES:

- FINISH GRADE TOLERANCES SHALL BE AS NOTED IN THE DETAILED SPECIFICATIONS. THE ENGINEER MAY MAKE GRADE CHANGES AS REQUIRED IN THE FIELD WITHOUT EFFECTING THE UNIT BID PRICE FOR UNCLASSIFIED EXCAVATION.
- UNLESS OTHERWISE STATED, ALL FILL AREAS SHALL BE CONSTRUCTED IN LAYERS OF 8" LIFTS, WITH WATER ADDED OR SOIL CONDITIONED TO THE OPTIMUM MOISTURE CONTENT AS DETERMINED BY THE ENGINEER OR CITY REPRESENTATIVE AND COMPACTED WITH A SHEEP'S FOOT ROLLER TO COMPACTION EQUAL TO OR GREATER THAN 95% (100% IN THE TOP 2 FT. OF THE SUB-GRADE BELOW ROADWAYS, ASPHALT AND CONCRETE DRIVEWAYS OR PARKING AREAS) OF THE DENSITY OBTAINED BY COMPACTING A SAMPLE OF MATERIAL IN ACCORDANCE WITH THE STANDARD PROCTOR METHOD OF MOISTURE-DENSITY RELATIONSHIP TEST, ASTM D698 OR AASHTO-99 UNLESS SPECIFIED ELSEWHERE.
- ENTIRE AREA TO BE GRADED SHALL BE CLEARED AND GRUBBED. NO FILL SHALL BE PLACED ON ANY AREA THAT HAS NOT BEEN CLEARED AND GRUBBED.
- ALL SOIL EROSION CONTROL MEASURES REQUIRED BY THE GRADING PLAN SHALL BE PERFORMED PRIOR TO GRADING, CLEARING OR GRUBBING. ALL EROSION CONTROL DEVICES SUCH AS SILT FENCES ETC. SHALL BE MAINTAINED IN WORKABLE CONDITION FOR THE LIFE OF THE PROJECT AND SHALL BE REMOVED AT THE COMPLETION OF THE PROJECT ONLY UPON THE ENGINEER/CITY REPRESENTATIVE'S APPROVAL. IF DURING THE LIFE OF THE PROJECT, A STORM CAUSES SOIL EROSION WHICH CHANGES THE THE FINISH GRADES OR CREATES "GULLIES" AND "WASHED AREAS". THESE SHALL BE REPAIRED AT NO EXTRA COST. ALL SILT WASHED OFF THE PROJECT SITE ONTO ADJACENT PROPERTIES SHALL BE REMOVED AS DIRECTED BY THE ENGINEER/CITY REPRESENTATIVE AT NO EXTRA COST. THE CONTRACTOR SHALL ADHERE TO ANY APPROVED EROSION CONTROL PLANS WHETHER INDICATED IN THE CONSTRUCTION PLANS OR UNDER SEPARATE COVER.
- DISPOSABLE MATERIAL
 - CLEARING AND GRUBBING WASTES SHALL BE REMOVED FROM THE SITE AND PROPERLY DISPOSED OF BY THE CONTRACTOR AT HIS EXPENSE, UNLESS SPECIFIED OTHERWISE.
 - SOLID WASTES TO BE REMOVED, SUCH AS SIDEWALKS, CURBS, PAVEMENT, ECT., MAY BE PLACED IN SPECIFIC DISPOSAL AREAS DELINEATED IN THE PLANS OR REMOVED FROM THE SITE AS REQUIRED BY THE SPECIFICATIONS. THIS MATERIAL SHALL HAVE A MINIMUM COVER OF 2 FT., THE CONTRACTOR SHALL MAINTAIN SPECIFIED COMPACTION REQUIREMENTS IN THESE AREAS. WHEN DISPOSAL SITES ARE NOT PROVIDED, THE CONTRACTOR SHALL REMOVE THE WASTE FROM THE SITE AND PROPERLY DISPOSE OF AT HIS EXPENSE.
 - ABANDONED UTILITIES, SUCH AS CULVERTS, WATER PIPE, HYDRANTS, CASTINGS, PIPE APPURTENANCES, UTILITY POLES, ECT., SHALL BE THE PROPERTY OF THE SPECIFIC UTILITY OWNER OR THE COMPANY HAVING JURISDICTION. BEFORE THE CONTRACTOR CAN REMOVE, DESTROY, SALVAGE, REUSE, SELL OR STORE FOR HIS OWN USE OF ANY ABANDONED UTILITY, HE MUST PRESENT THE OWNER'S WRITTEN PERMISSION FROM THE UTILITY INVOLVED.
- IN THE EVENT EXCESSIVE GROUNDWATER OR SPRINGS ARE ENCOUNTERED WITHIN THE LIMITS OF CONSTRUCTION, THE CONTRACTOR SHALL INSTALL NECESSARY UNDER DRAINS AND STONE AS DIRECTED BY THE ENGINEER. ALL WORK SHALL BE PAID BASED UPON UNITY BIDS, UNLESS SPECIFIED OTHERWISE.
- THE CONTRACTOR IS RESPONSIBLE FOR THE COORDINATION OF ALL UTILITY SURFACE ACCESSES.
- THE CONTRACTOR SHALL CONTROL ALL "DUST" BE PERIODIC WATERING AND SHALL PROVIDE ACCESS AT ALL TIMES FOR PROPERTY OWNERS WITHIN THE PROJECT AREA AND FOR EMERGENCY VEHICLES. ALL OPEN DITCHES AND HAZARDOUS AREAS SHALL BE CLEARLY MARKED IN ACCORDANCE WITH THE SPECIFICATIONS.
- THE FINISHED SURFACE SHALL BE SMOOTH, FREE OF ALL ROCKS LARGER THAN 3", EQUIPMENT TRACKS, DIRT CLOUDS, BUMPS, RIDGES AND GOUGES PRIOR TO SEEDING; THE SURFACE SHALL BE LOOSENE TO A DEPTH OF ±4"-6" TO ACCEPT SEED. THE CONTRACTOR SHALL NOT PROCEED WITH SEEDING OPERATIONS WITHOUT FIRST OBTAINING THE ENGINEER/CITY REPRESENTATIVE'S APPROVAL OF THE GRADED SURFACE. HAND SEEDING IN CERTAIN AREAS SHALL BE AUTHORIZED ON A CASE BY CASE BASES BY THE ENGINEER/CITY REPRESENTATIVE.
- THE CONTRACTOR SHALL VERIFY ALL ELEVATIONS BEFORE INSTALLATION OF FACILITIES.
- THE CONTRACTOR SHALL NOTIFY THE PROPER AUTHORITIES AT LEAST 24 HOURS PRIOR TO ANY ROAD CLOSURES FOR CONSTRUCTION, INCLUDING BUT NOT LIMITED TO LOCAL NEWSPAPER, RADIO STATION, FIRE DEPARTMENT, CITY POLICE DEPARTMENT, AMBULANCE AND COUNTY EMERGENCY AGENCY. ALL TRAFFIC CONTROL SHALL CONFORM TO THE REQUIREMENTS OF THE TENNESSEE DEPARTMENT OF TRANSPORTATION.
- THE LOCATION AND DEPTH OF ALL EXISTING UNDERGROUND UTILITIES SHOWN IN THE PLANS ARE APPROXIMATE ONLY AND SHALL BE FIELD VERIFIED PRIOR TO THE CONTRACTOR COMMENCING CONSTRUCTION. THE CONTRACTOR SHALL NOTIFY THE ENGINEER OF ANY REQUIRED MODIFICATIONS IMMEDIATELY. THE CONTRACTOR SHALL CONTACT EACH UTILITY OWNERS OR TENNESSEE ONE CALL (811) AND HAVE EACH UNDERGROUND UTILITY LOCATED AT LEAST 72 HOURS PRIOR TO COMMENCING CONSTRUCTION.
- THE NAMES OF PROPERTY OWNERS, PROPERTY LINES, STREET AND ROAD RIGHTS-OF-WAY SHOWN ON THESE PLANS WERE OBTAINED FROM THE ROBERTSON COUNTY GIS MAPS. INFORMATION IS ONLY GENERAL IN NATURE AND IS NOT GUARANTEED BY THE ENGINEER.
- THE CONTRACTOR SHALL BE RESPONSIBLE FOR THE REPAIR AND/OR REPLACEMENT OF ALL EXISTING DRAINAGE CULVERTS DISTURBED DURING CONSTRUCTION. NO ADDITIONAL PAYMENT WILL BE MADE FOR THIS WORK.
- ALL MATERIALS AND CONSTRUCTION METHODS SHALL BE AS SPECIFIED AND DETAILED IN THE CITY OF WHITE HOUSE'S "STANDARD SEWER SYSTEM SPECIFICATIONS" AND "STANDARD SEWER DETAILS" FOUND AT : <http://cityofwhitehouse.com/government/wastewater>

SEWER CONSTRUCTION NOTES:

- ALL CONSTRUCTION OUTSIDE OF RIGHT-OF-WAY SHALL TAKE PLACE WITHIN THE PERMANENT AND TEMPORARY EASEMENTS SHOWN.
- THE CONTRACTOR SHALL REPAIR ALL DISTURBED AREAS TO EQUAL OR BETTER CONDITION THAN ORIGINAL, OR AS NOTED.
- THE CONTRACTOR SHALL BE STRICTLY AND SOLELY LIABLE FOR ANY FINES LEVIED BY ANY REGULATORY AGENCY DUE TO VIOLATION OF WATER QUALITY IN THE STREAMS CAUSED BY CONSTRUCTION ACTIVITIES. THE CONTRACTOR SHALL USE ALL NECESSARY TEMPORARY WATER POLLUTION CONTROL MEANS AS SPECIFIED TO PREVENT TRANSPORT OF SEDIMENT INTO THOSE WATERWAYS AT NO ADDITIONAL COST TO THE OWNER.
- ALL WORK NEAR AND AROUND WATERWAYS SHALL UNIFORM TO THE RULES OF STATE OF TENNESSEE.
- CONTRACTOR SHALL FOLLOW ALL FEDERAL, STATE AND LOCAL HEALTH AND SAFETY REGULATIONS PERTAINING TO CONSTRUCTION OPERATIONS.
- SEWER LINES SHALL HAVE A MINIMUM OF 4'-0" OF COVER UNLESS SHOWN OTHERWISE IN THE DRAWINGS.
- WATER AND SEWER LINES SHALL HAVE A MINIMUM OF 10 FT. HORIZONTAL SEPARATION OR A MINIMUM OF 18" VERTICAL SEPARATION WITH THE WATER LINE ABOVE THE SEWER, OR BOTH WATER AND SEWER LINES SHALL BE DUCTILE IRON PIPE FOR 10 FT. EACH SIDE OF THE CROSSING.
- SANITARY AND STORM SEWER LINES SHALL HAVE A MINIMUM OF 18" VERTICAL SEPARATION.
- UNLESS NOTED OTHERWISE, ALL PIPES SHALL BE INSTALLED WITH PUSH-ON JOINTS.
- LEGAL DESCRIPTIONS FOR PROPOSED EASEMENTS BY OTHERS.
- LOCATIONS SHOWN FOR SANITARY SEWER SERVICES ARE ASSUMED. COORDINATE LOCATION OF ALL PROPOSED SEWER SERVICE CONNECTIONS WITH PROPERTY OWNER AND FIELD CONDITIONS.
- CONTRACTOR SHALL FIELD VERIFY ALL PROPOSED MANHOLE TOP ELEVATIONS AND EXISTING MANHOLE INVERTS PRIOR TO CONSTRUCTION AND NOTIFY THE CITY REPRESENTATIVE OF ANY DISCREPANCIES. CONTRACTOR SHALL ADJUST ALL PROPOSED SEWER STRUCTURES TO MATCH FINISHED GRADE ELEVATIONS. COST OF RAISING THE STRUCTURES SHALL BE CONSIDERED INCIDENTAL AND ADDED TO THE COST OF THE MANHOLE.
- MANHOLES AND CASTINGS SHALL MEET THE REQUIREMENTS OF THE CITY AS WELL THE PROJECT SPECIFICATIONS.
- ANY FENCING DAMAGED DURING CONSTRUCTION SHALL BE REPLACED WITH LIKE MATERIAL IN A WORKMAN LIKE MANNER AND IN ACCORDANCE TO THE SPECIFICATIONS AT THE CONTRACTOR'S EXPENSE. THIS DOES NOT INCLUDE ADDITIONAL FENCE CALLED OUT IN THE PLANS.
- CONTRACTOR SHALL BE RESPONSIBLE FOR ANY DAMAGE TO EXISTING ROADS DURING CONSTRUCTION AND SHALL REPAIR ROADS PER REQUIREMENTS OF THE TENNESSEE DEPARTMENT OF TRANSPORTATION OR THE CITY OF WHITE HOUSE. SAND OR A SIMILAR MATERIAL APPROVED BY THE TENNESSEE DEPARTMENT OF TRANSPORTATION SHALL BE PLACED AS A PROTECTIVE BARRIER BETWEEN TRACKED EQUIPMENT AND THE ROAD AND CLEANED UP PROPERLY AFTER CONSTRUCTION. A MINIMUM OF 2" OF SAND SHALL BE PLACED ON THE ROAD PRIOR TO STOCKPILING SPOIL MATERIAL ON THE ROAD SURFACE TO FACILITATE CLEANUP.

GENERAL CONSTRUCTION NOTE:

ANY BYPASS PUMPING REQUIRED TO PERFORM THE CONTRACT SHALL BE THE SOLE RESPONSIBILITY OF THE CONTRACTOR. BYPASS PUMPING IS NOT A SEPARATE PAY ITEM & BYPASSING OF RAW SEWAGE WILL NOT BE PERMITTED.

ESTIMATED QUANTITIES			
Item No.	Description	Unit	Estimated Quantity
1	CONSTRUCTION STAKES, LINES, AND GRADES	LS	1
2	CLEARING AND GRUBBING	LS	1
3	18" DR 21 PVC C905 FORCE MAIN	LF	4800
3	COMBINATION AIR VALVE	EA	4
3	CONNECTION PER DETAILS AT BEGIN AND END OF FORCE MAIN	LS	1
4	TYPICAL PAVEMENT REPAIR-PATCH	SY	2200
5	BACKFILL (STONE)	TON	260
5	PAVEMENT MARKING	LS	1
6	TRAFFIC CONTROL	LS	1
6	MOBILIZATION	LS	1
7	EROSION CONTROL	LS	1

FOOTNOTES:

- ALL DIMENSIONAL DETAILS SHOWN ON PLANS, INCLUDING ELEVATIONS SHALL BE CHECKED BY THE CONTRACTOR TO ENSURE ACCURACY OF THE LAYOUT PRIOR TO CONSTRUCTION. ANY ERRORS AND APPARENT DISCREPANCIES FOUND IN PREVIOUS SURVEYS OR IN EITHER THE SPECIFICATIONS OR SPECIAL PROVISIONS, SHALL BE CALLED TO THE ENGINEERS ATTENTION BY THE CONTRACTOR IMMEDIATELY AND PRIOR TO PROCEEDING WITH WORK.
- EXCAVATION AND PIPE BEDDING MATERIAL FOR PIPE WILL NOT BE MEASURED AND PAID FOR DIRECTLY, BUT THE COST WILL BE INCLUDED IN THE COST OF THE PROPOSED FORCE MAIN.
- ITEM INCLUDES ALL MATERIAL AND LABOR, NOT LISTED ABOVE TO CONNECT TO THE EXISTING SYSTEM.
- ITEM INCLUDES ALL MATERIAL AND LABOR TO REPAIR THE PAVEMENT EQUAL TO OR EXCEEDING EXISTING CONDITIONS.
- ITEM INCLUDES ADDITIONAL STONE BACKFILL REQUIRED BETWEEN THE STONE INCLUDED IN THE PIPE INSTALLATION AND THE FINAL SURFACE MATERIAL.
- INCLUDES ALL TEMPORARY TRAFFIC CONTROL EQUIPMENT, SIGNS, AND LABOR THROUGHOUT THE PROJECT.
- INCLUDES MATERIAL, LABOR, INSTALLATION AND MAINTENANCE OF THE EROSION CONTROL. AND SEEDING AND MULCH FOR ALL DISTURBED AREAS WITHIN THE PROJECT LIMITS. ALL AREAS DISTURBED OUTSIDE PROJECT WILL BE STABILIZED AT NO ADDITIONAL COST TO THE OWNER.



GENERAL NOTES
SOUTHERN FORCE MAIN
 FOR
THE CITY OF WHITE HOUSE
 SAGE RD.
 WHITE HOUSE, TN 37188
 ROBERTSON COUNTY

NO.	DATE	BY	DESCRIPTION

DESIGNER **KLO**
 REVIEWER **PLC**

PROJECT **21-902**

DATE **3/24/2022**

SHEET **G-002**



PURPOSE FOR ISSUE: OWNER REVIEW

SCALE: NONE

CONSTRUCTION NOTE:

- ALL TREES SHOWN TO BE REMOVED
- ALL FITTINGS/BENDS SHALL BE DUCTILE IRON MECHANICAL JOINT WITH SERIES 2000PV MEGALUG MECHANICAL JOINT RESTRAINT
- ALL BELL ENDS IMMEDIATELY BEFORE AND AFTER EACH FITTING /BEND SHALL HAVE BELL RESTRAINT HARNESS
EBAA SERIES 1500 (4-12" DIA. PIPE)
EBAA SERIES 2800 (14-54" DIA. PIPE)
- ALL FITTINGS/ BENDS SHALL BE COATED WITH PROTECTED 401 OR APPROVED EQUAL
- ALL VALVE CLUSTERS SHALL BE JOINED TO FITTINGS WITH PROTECTED 401 COATED FOSTER ADAPTERS
- SEE CITY OF WHITE HOUSE STANDARD DETAILS FOR THRUST BLOCKING
- ALL WORK TO BE PERFORMED NEAR THE ROADWAY RESULTING IN A NEED FOR TRAFFIC CONTROL SHALL CONFORM TO CURRENT EDITION OF MUTCD

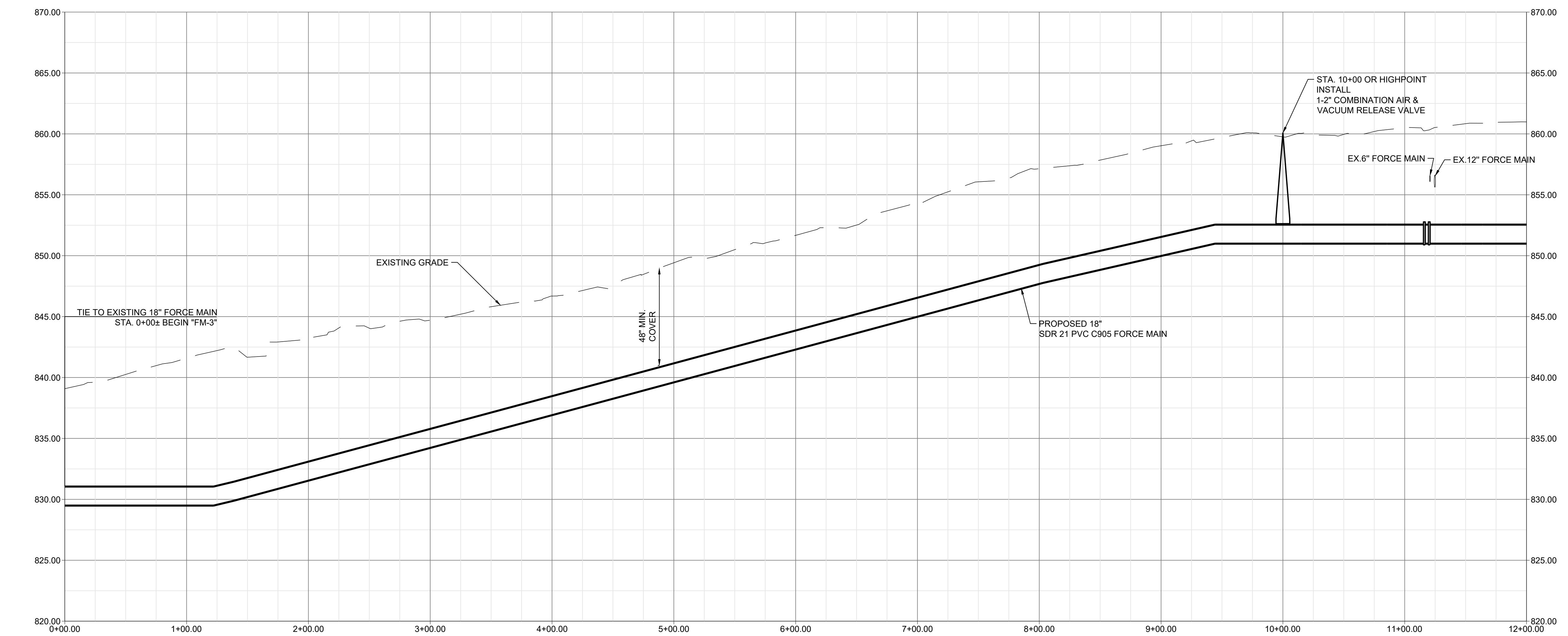
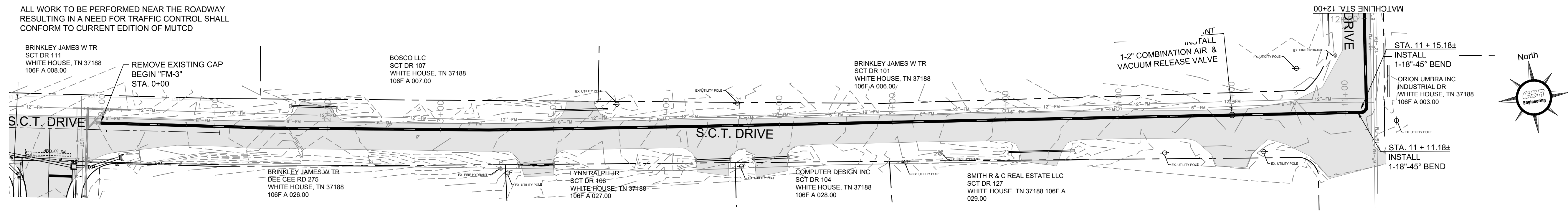

PROFILE VIEW
"FM-3"
HORIZ. SCALE: 1" = 50'
VERT. SCALE: 1" = 5'



PURPOSE FOR ISSUE: OWNER REVIEW

SCALE: 1"=50'



LINE "FM-3"
STA. 0+00 TO 12+00
SOUTHERN FORCE MAIN
FOR
THE CITY OF WHITE HOUSE
SAGE RD.
WHITE HOUSE, TN 37188
ROBERTSON COUNTY

REVISIONS	
NO.	DESCRIPTION

DESIGNER KLO
REVIEWER PLC

PROJECT 21-902

DATE 3/24/2022

SHEET C-101

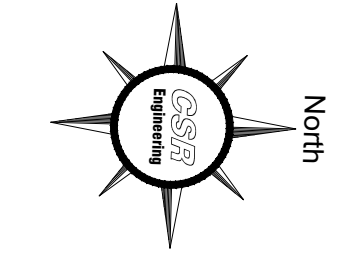
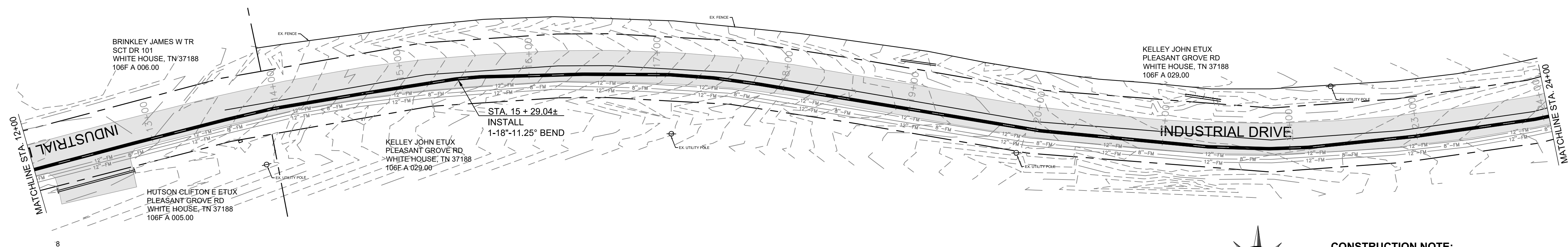

CONSTRUCTION NOTE:

ALL FITTINGS/BENDS SHALL BE DUCTILE IRON MECHANICAL JOINT WITH SERIES 2000PV MEGALUG MECHANICAL JOINT RESTRAINT

ALL BELL ENDS IMMEDIATELY BEFORE AND AFTER EACH FITTING /BEND SHALL HAVE BELL RESTRAINT HARNESS
 EBAA SERIES 1500 (4-12" DIA. PIPE)
 EBAA SERIES 2800 (14-54" DIA. PIPE)

ALL FITTINGS/ BENDS SHALL BE COATED WITH PROTECTED 401 OR APPROVED EQUAL

ALL VALVE CLUSTERS SHALL BE JOINED TO FITTINGS WITH PROTECTED 401 COATED FOSTER ADAPTERS

SEE CITY OF WHITE HOUSE STANDARD DETAILS FOR THRUST BLOCKING

ALL WORK TO BE PERFORMED NEAR THE ROADWAY RESULTING IN A NEED FOR TRAFFIC CONTROL SHALL CONFORM TO CURRENT EDITION OF MUTCD

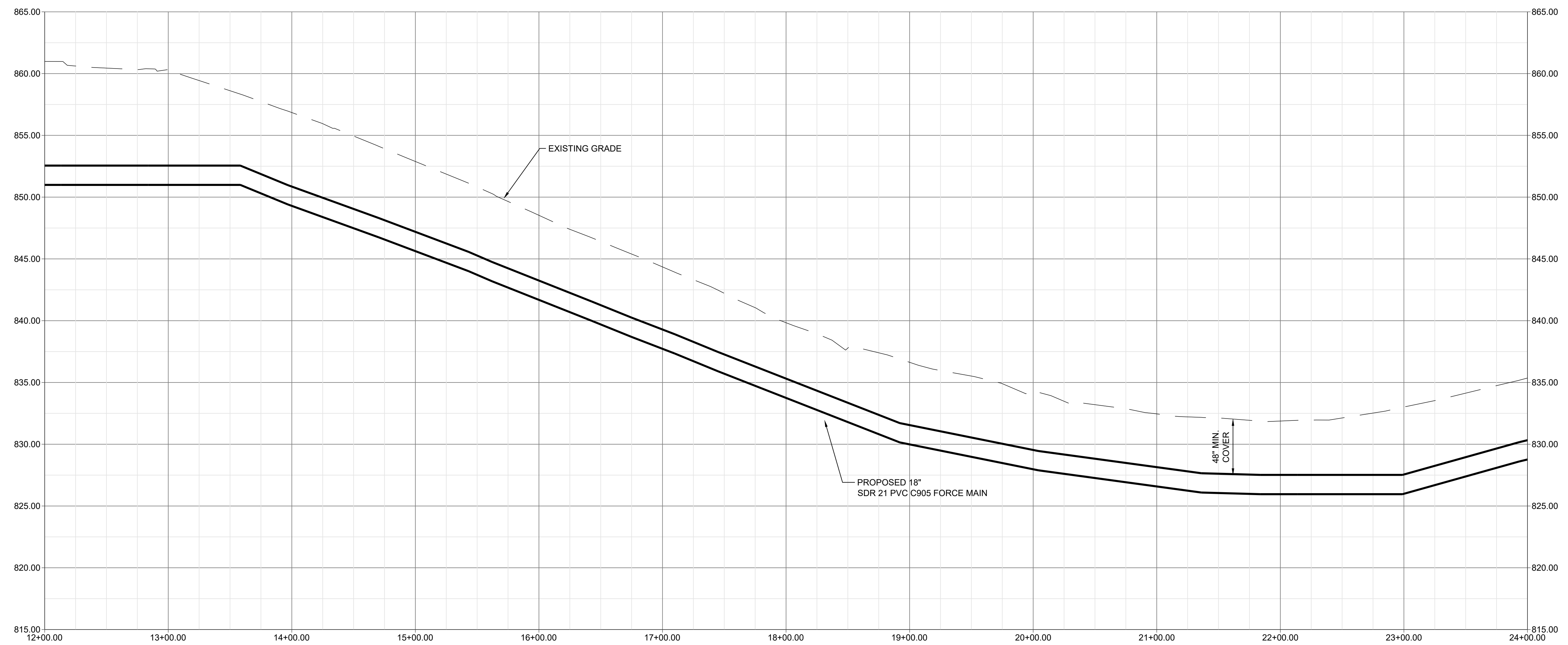

PROFILE VIEW
 "FM-3"
 HORIZ. SCALE: 1" = 50'
 VERT. SCALE: 1" = 5'

NOTE: CONTRACTOR TO VERIFY EX. UTILITY DEPTHS & ADJUST DEPTH TO MAINTAIN REQUIRED VERTICAL SEPARATION BETWEEN EX. WATER MAIN AND PROPOSED SAN. SEWER



SCALE: 1"=50'



LINE "FM-3"
 STA. 12+00 TO 24+00
 SOUTHERN FORCE MAIN
 FOR
 THE CITY OF WHITE HOUSE
 SAGE RD.
 WHITE HOUSE, TN 37188
 ROBERTSON COUNTY

REVISIONS	
NO.	DESCRIPTION

DESIGNER KLO
 REVIEWER PLC

PROJECT 21-902

DATE 3/24/2022

SHEET C-102



PURPOSE FOR ISSUE: OWNER REVIEW

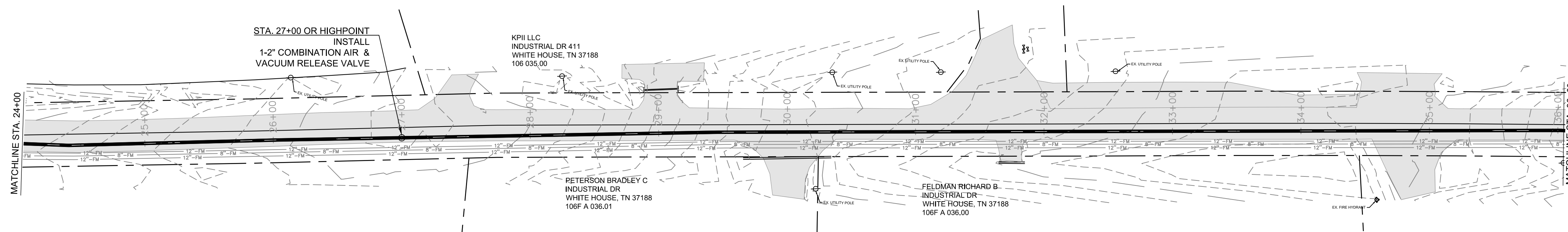

CONSTRUCTION NOTE:

ALL FITTINGS/BENDS SHALL BE DUCTILE IRON MECHANICAL JOINT WITH SERIES 2000PV MEGALUG MECHANICAL JOINT RESTRAINT

ALL BELL ENDS IMMEDIATELY BEFORE AND AFTER EACH FITTING /BEND SHALL HAVE BELL RESTRAINT HARNESS
 EBAA SERIES 1500 (4-12" DIA. PIPE)
 EBAA SERIES 2800 (14-54" DIA. PIPE)

ALL FITTINGS/ BENDS SHALL BE COATED WITH PROTECTED 401 OR APPROVED EQUAL

ALL VALVE CLUSTERS SHALL BE JOINED TO FITTINGS WITH PROTECTED 401 COATED FOSTER ADAPTERS

SEE CITY OF WHITE HOUSE STANDARD DETAILS FOR THRUST BLOCKING

ALL WORK TO BE PERFORMED NEAR THE ROADWAY RESULTING IN A NEED FOR TRAFFIC CONTROL SHALL CONFORM TO CURRENT EDITION OF MUTCD

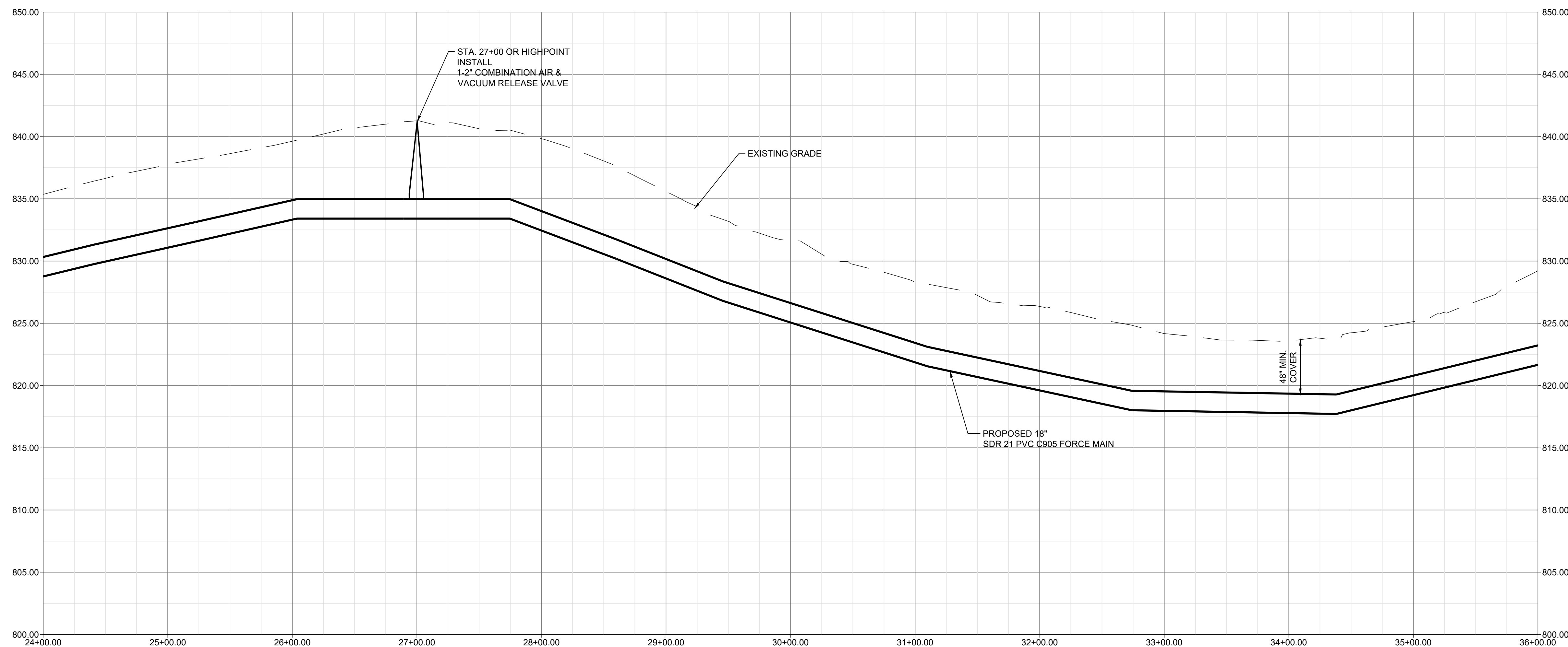
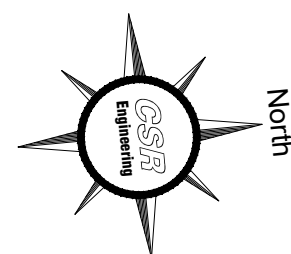

PROFILE VIEW
 "FM-3"
 HORIZ. SCALE: 1" = 50'
 VERT. SCALE: 1" = 5'

NOTE: CONTRACTOR TO VERIFY EX. UTILITY DEPTHS & ADJUST DEPTH TO MAINTAIN REQUIRED VERTICAL SEPARATION BETWEEN EX. WATER MAIN AND PROPOSED SAN. SEWER



SCALE: 1"=50'

PURPOSE FOR ISSUE: OWNER REVIEW



LINE "FM-3"
 STA. 24+00 TO 36+00
 SOUTHERN FORCE MAIN
 FOR
 THE CITY OF WHITE HOUSE
 SAGE RD.
 WHITE HOUSE, TN 37188
 ROBERTSON COUNTY

REVISIONS	
NO.	DESCRIPTION

DESIGNER KLO
 REVIEWER PLC

PROJECT 21-902

DATE 3/24/2022

SHEET C-103

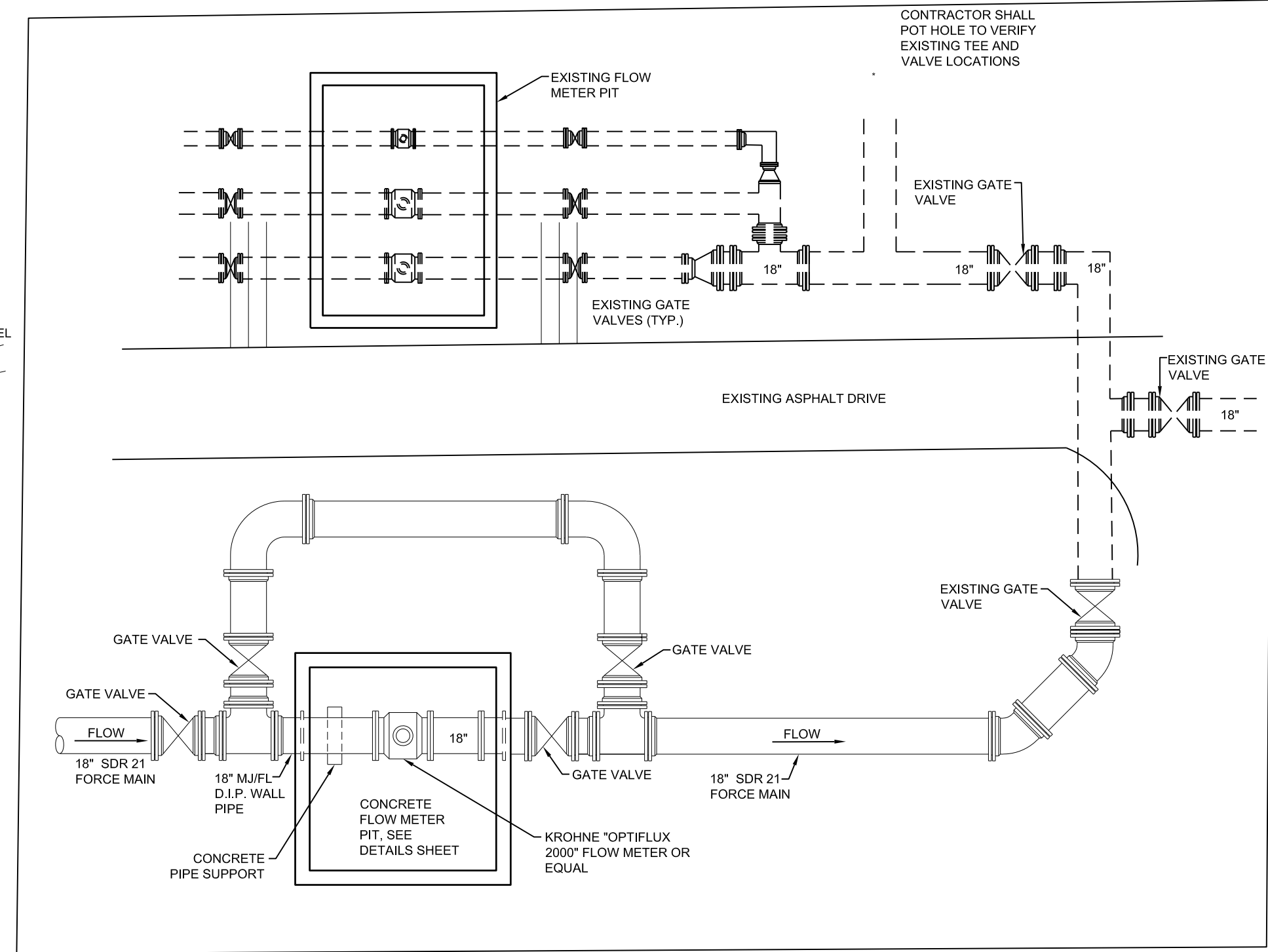
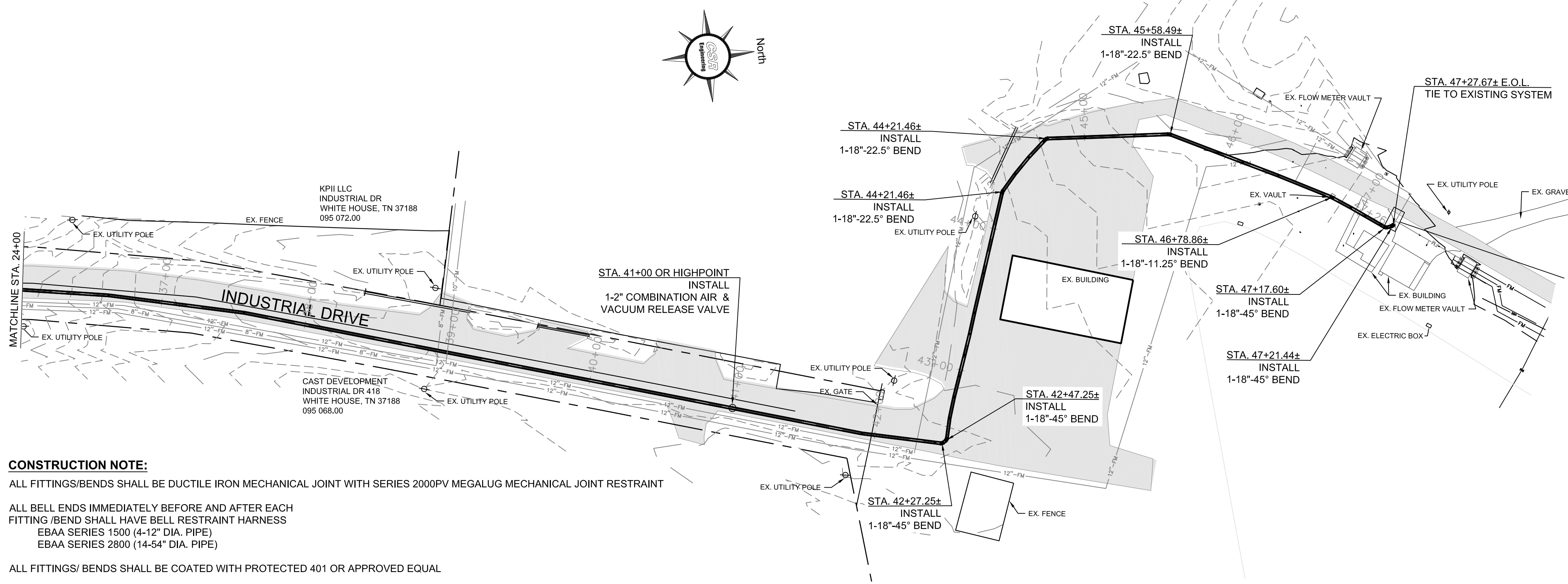

CONSTRUCTION NOTE:
 ALL FITTINGS/BENDS SHALL BE DUCTILE IRON MECHANICAL JOINT WITH SERIES 2000PV MEGALUG MECHANICAL JOINT RESTRAINT
 ALL BELL ENDS IMMEDIATELY BEFORE AND AFTER EACH FITTING /BEND SHALL HAVE BELL RESTRAINT HARNESS
 EBAA SERIES 1500 (4-12" DIA. PIPE)
 EBAA SERIES 2800 (14-54" DIA. PIPE)
 ALL FITTINGS/ BENDS SHALL BE COATED WITH PROTECTED 401 OR APPROVED EQUAL
 ALL VALVE CLUSTERS SHALL BE JOINED TO FITTINGS WITH PROTECTED 401 COATED FOSTER ADAPTERS
 SEE CITY OF WHITE HOUSE STANDARD DETAILS FOR THRUST BLOCKING
 ALL WORK TO BE PERFORMED NEAR THE ROADWAY RESULTING IN A NEED FOR TRAFFIC CONTROL SHALL CONFORM TO CURRENT EDITION OF MUTCD

TIE-IN DETAIL

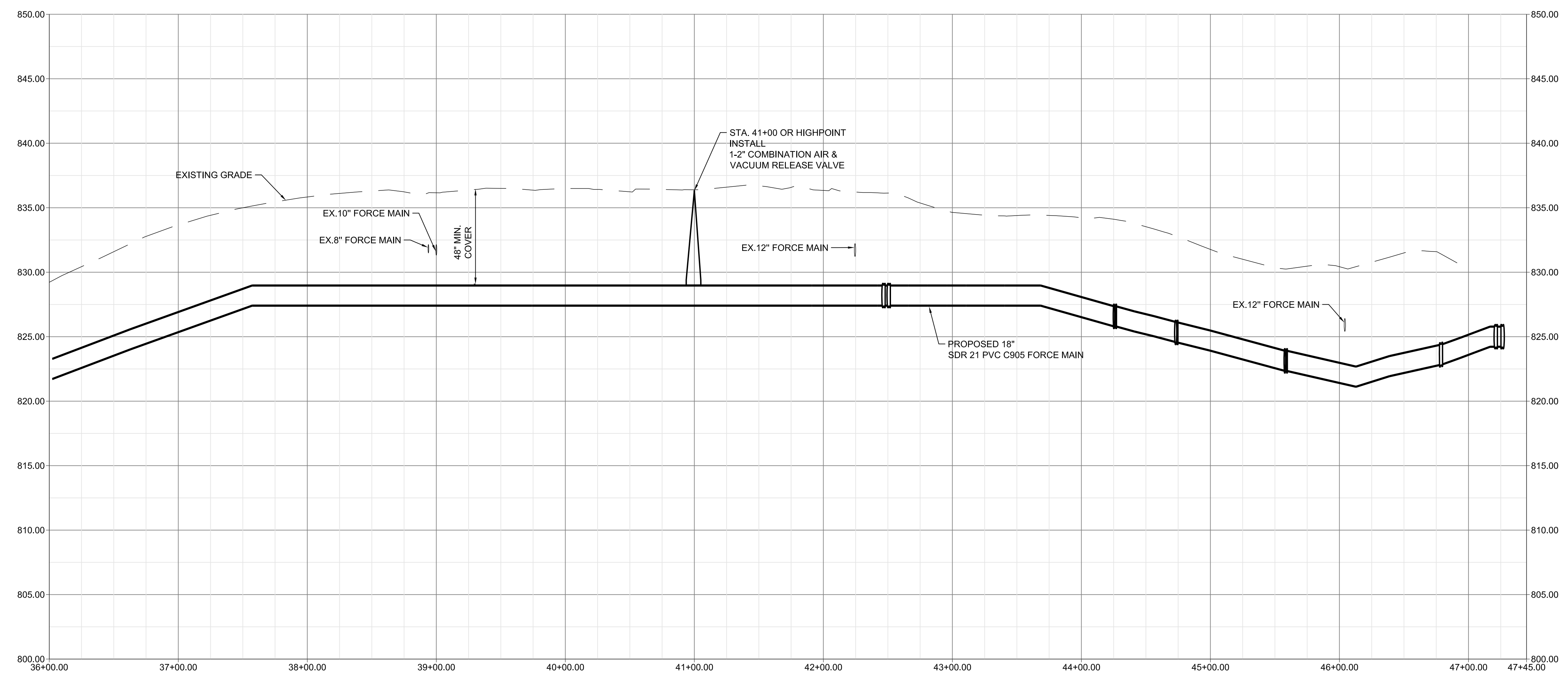

PROFILE VIEW
 "FM-3"
 HORIZ. SCALE: 1" = 50'
 VERT. SCALE: 1" = 5'

NOTE: CONTRACTOR TO VERIFY EX. UTILITY DEPTHS & ADJUST DEPTH TO MAINTAIN REQUIRED VERTICAL SEPARATION BETWEEN EX. WATER MAIN AND PROPOSED SAN. SEWER

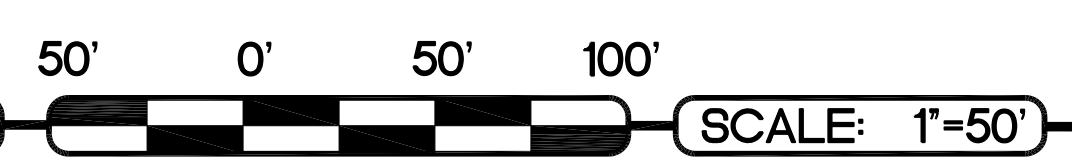

LINE "FM-3"
 STA. 36+00 TO E.O.L.
 SOUTHERN FORCE MAIN
 FOR
 THE CITY OF WHITE HOUSE
 SAGE RD.
 WHITE HOUSE, TN 37188
 ROBERTSON COUNTY

REVISIONS	
NO.	DESCRIPTION

DESIGNER KLO
 REVIEWER PLC

PROJECT 21-902

DATE 3/24/2022

SHEET C-104



PURPOSE FOR ISSUE: OWNER REVIEW

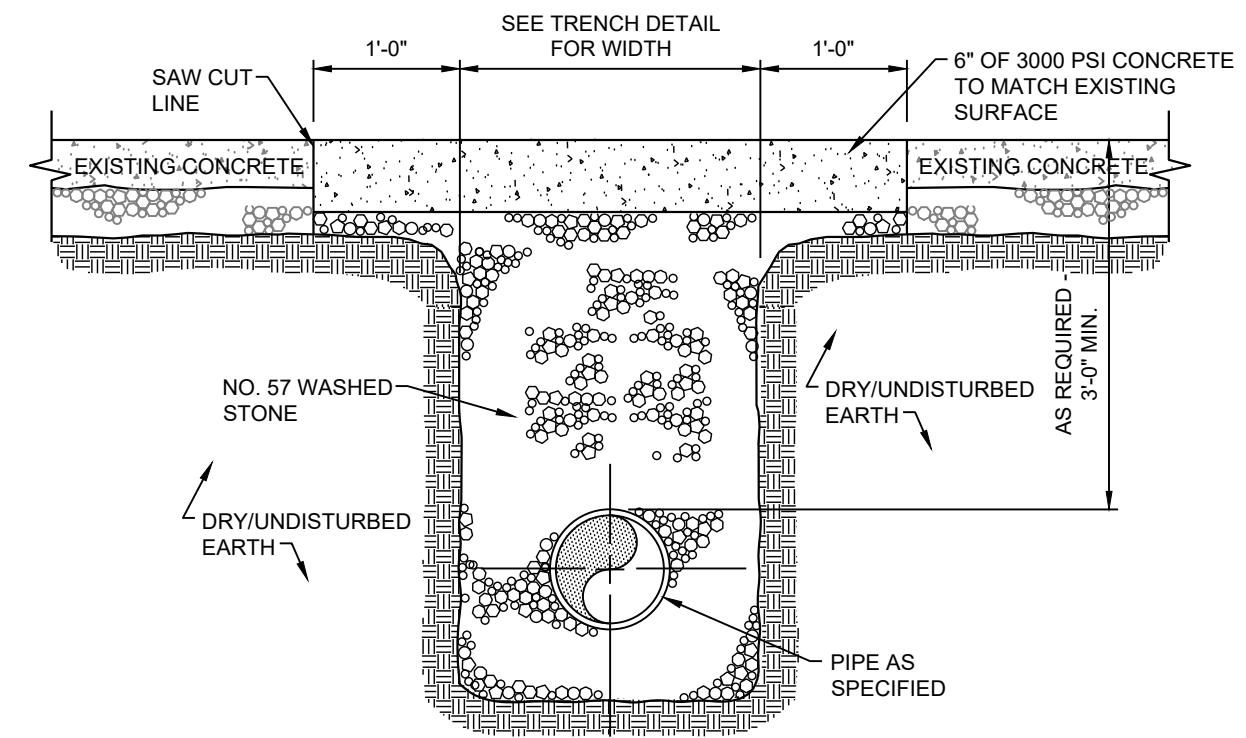

CONCRETE DRIVE REPAIR DETAIL
NOT TO SCALE

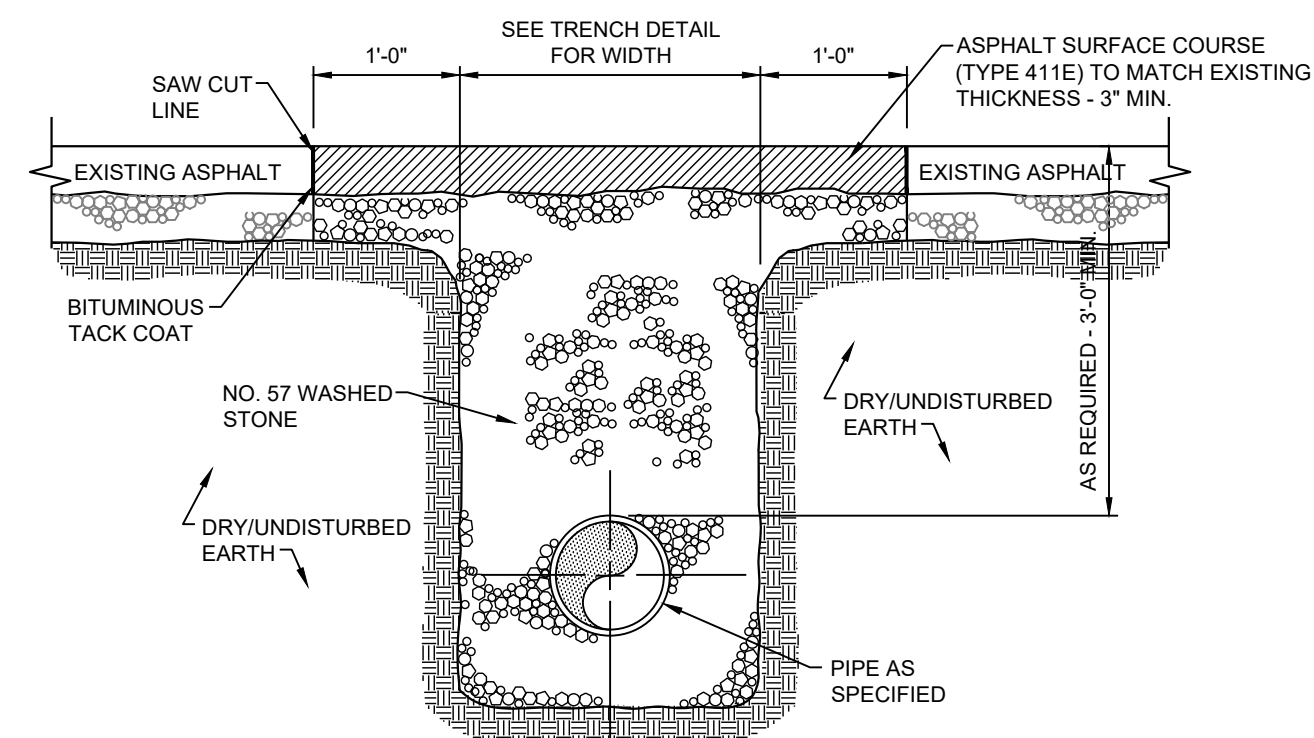

ASPHALT DRIVE REPAIR DETAIL
NOT TO SCALE

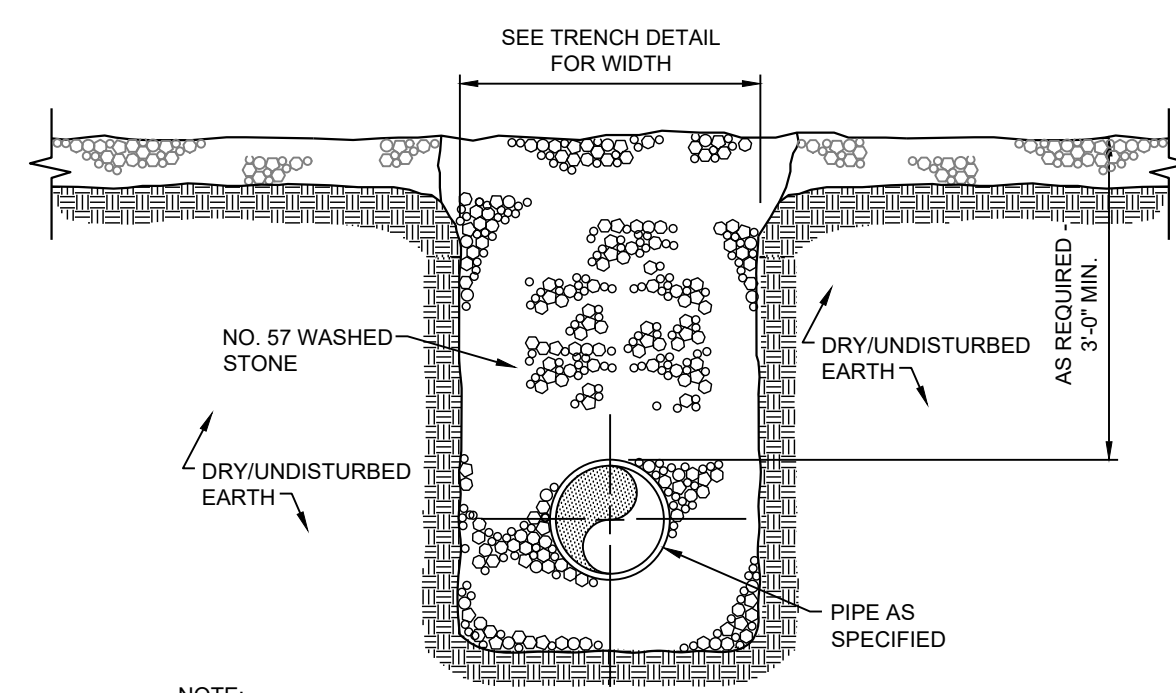

GRAVEL DRIVE REPAIR DETAIL
NOT TO SCALE

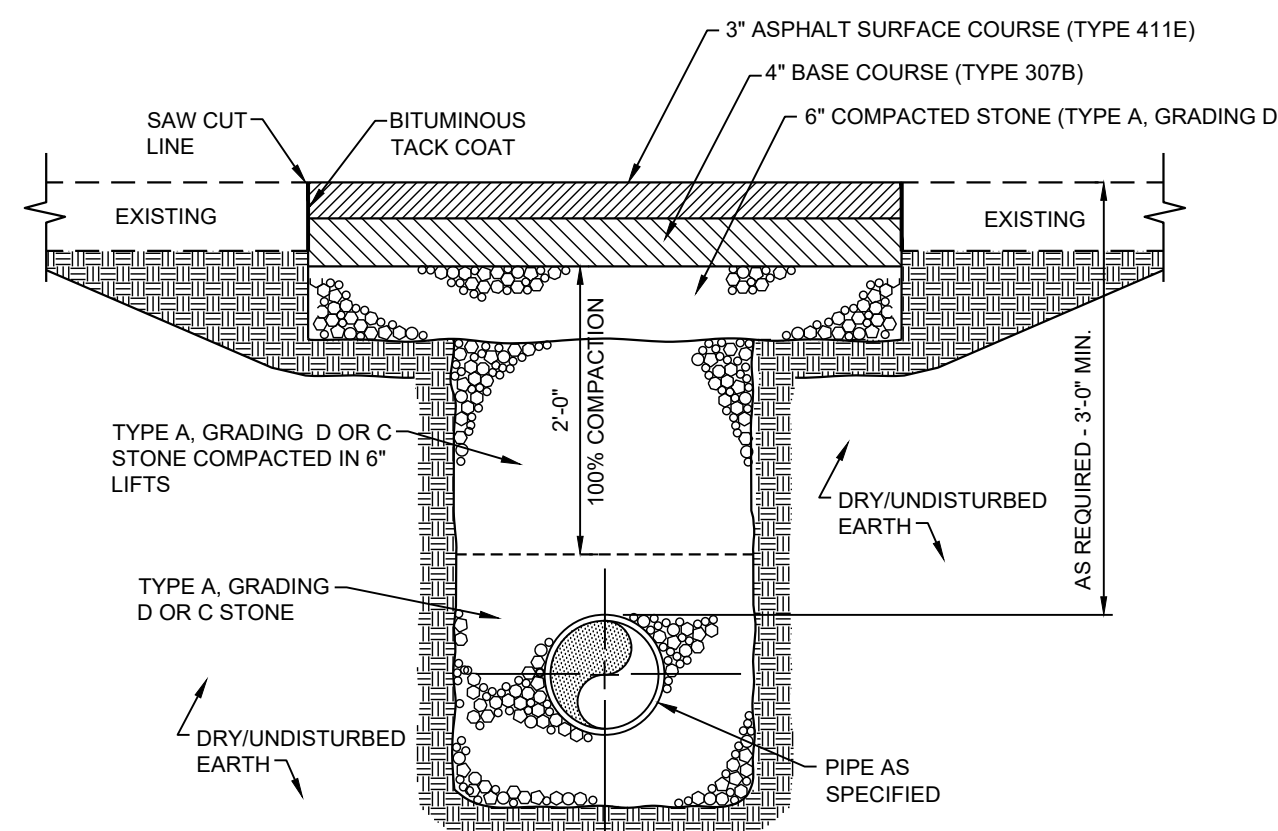

TYPICAL PAVEMENT REPAIRS - PATCH
NOT TO SCALE

NOTE:
1. SAWED EDGES SHALL BE NEAT AND SQUARE AND SAWN WITH A CONCRETE SAW. BROOMED CLEAN OF DUST PRIOR TO TACK COAT BEING APPLIED.
2. CRS-I OR CRS-II TACK COAT SHALL BE APPLIED TO THE EDGES.
3. CONTRACTOR SHALL BE RESPONSIBLE FOR REPLACEMENT ON ANY PAVEMENT MARKINGS DISTURB OR COVERED BY OVERLAY. NO EXTRA PAYMENT WILL BE MADE.

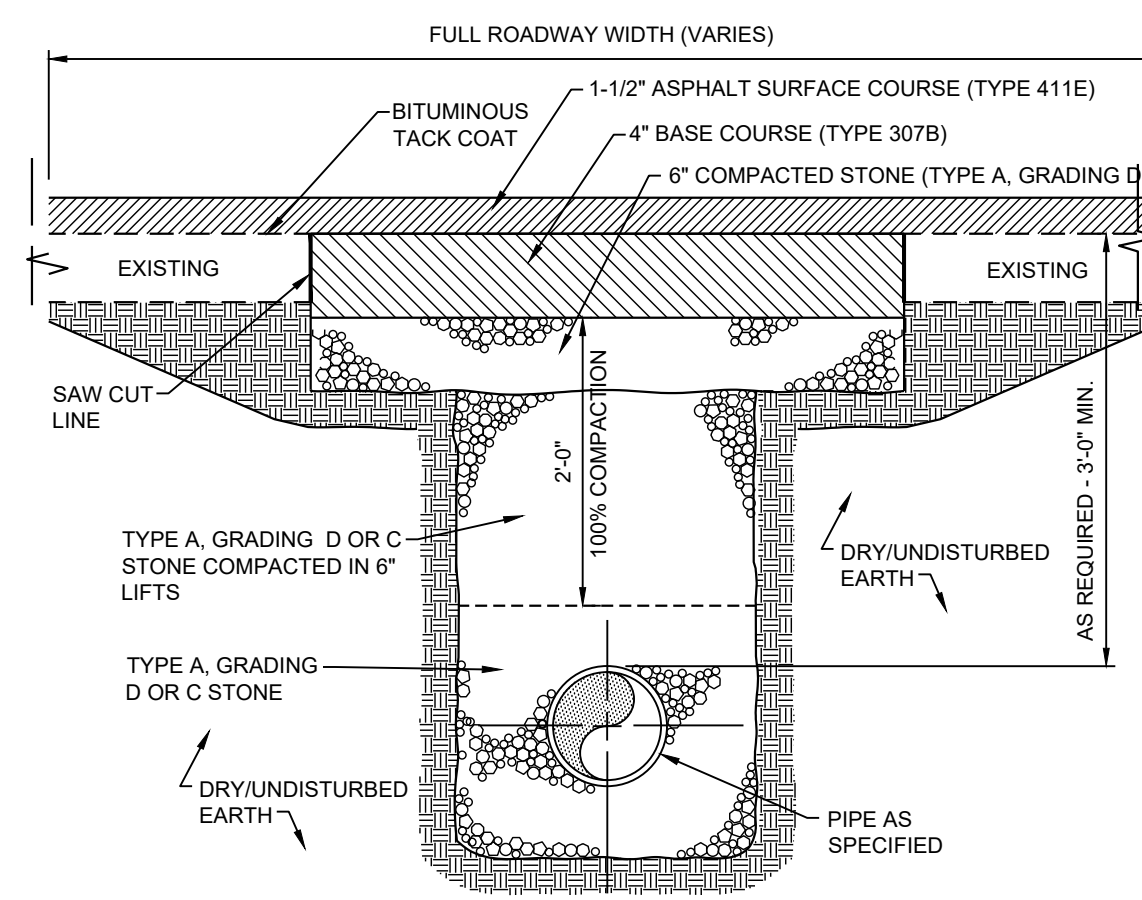

TYPICAL PAVEMENT REPAIRS - OVERLAY
NOT TO SCALE

NOTE:
1. SAWED EDGES SHALL BE NEAT AND SQUARE AND SAWN WITH A CONCRETE SAW. BROOMED CLEAN OF DUST PRIOR TO TACK COAT BEING APPLIED.
2. CRS-I OR CRS-II TACK COAT SHALL BE APPLIED TO THE EDGES.
3. CONTRACTOR SHALL BE RESPONSIBLE FOR REPLACEMENT ON ANY PAVEMENT MARKINGS DISTURB OR COVERED BY OVERLAY. NO EXTRA PAYMENT WILL BE MADE.

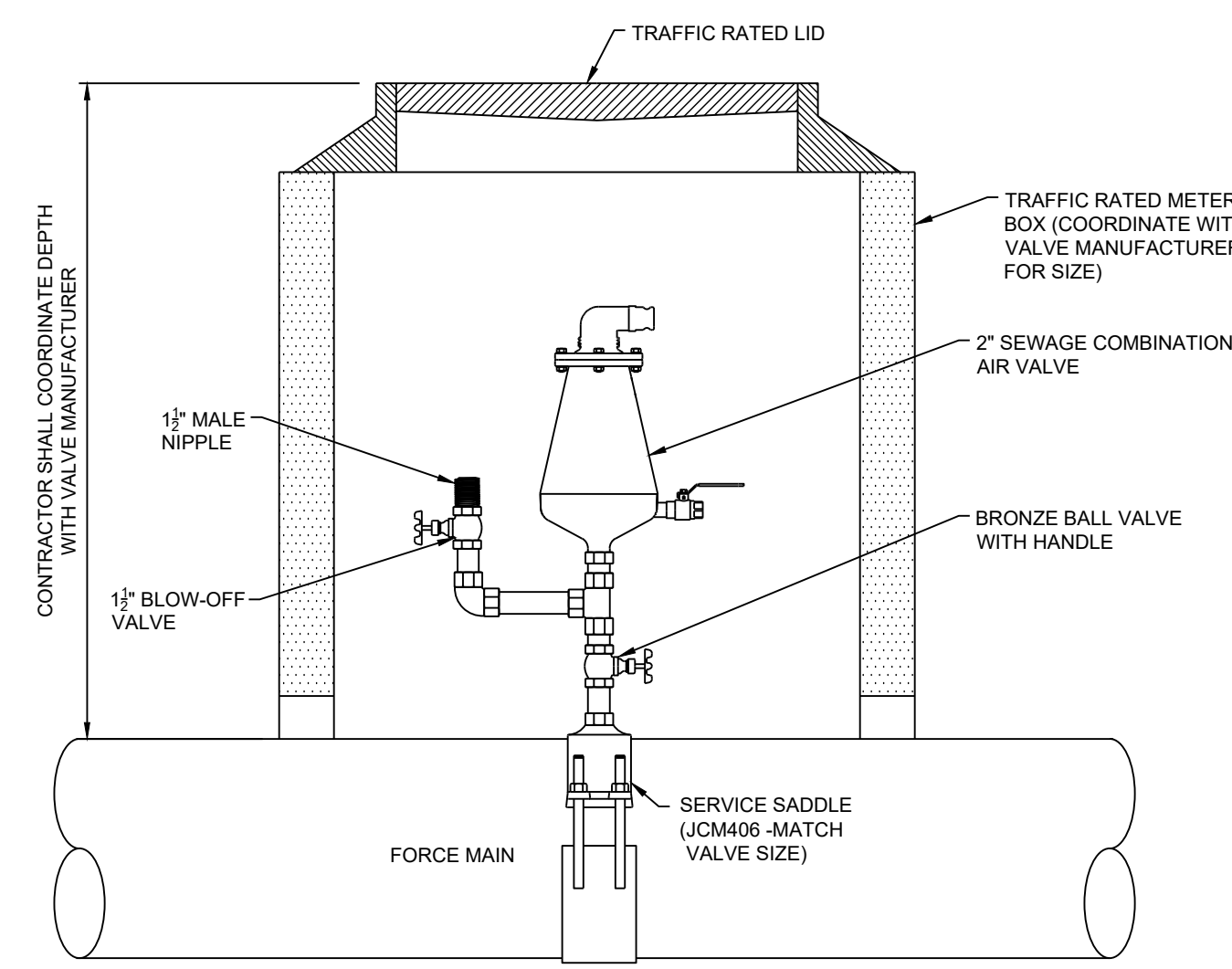

SEWAGE FORCE MAIN COMBINATION AIR VALVE
NOT TO SCALE

NOTES:
1. COMBINATION AIR VALVE TO BE INSTALLED AT ACTUAL HIGH POINT OF LINE. CONTRACTOR TO COORDINATE LOCATION WITH ENGINEER OR REPRESENTATIVE.
2. VALVE SIZE AS SHOWN ON DRAWINGS OR DETAILED SPECIFICATIONS.
3. ALL PIPING FOR COMBINATION AIR VALVE SHALL BE BRASS OR STAINLESS STEEL.
4. CONTRACTOR SHALL ADJUST THE DEPTH OF THE FORCE MAIN AT ALL HIGH POINTS TO ACCOMMODATE THE INSTALLATION OF THE COMBINATION VALVE.

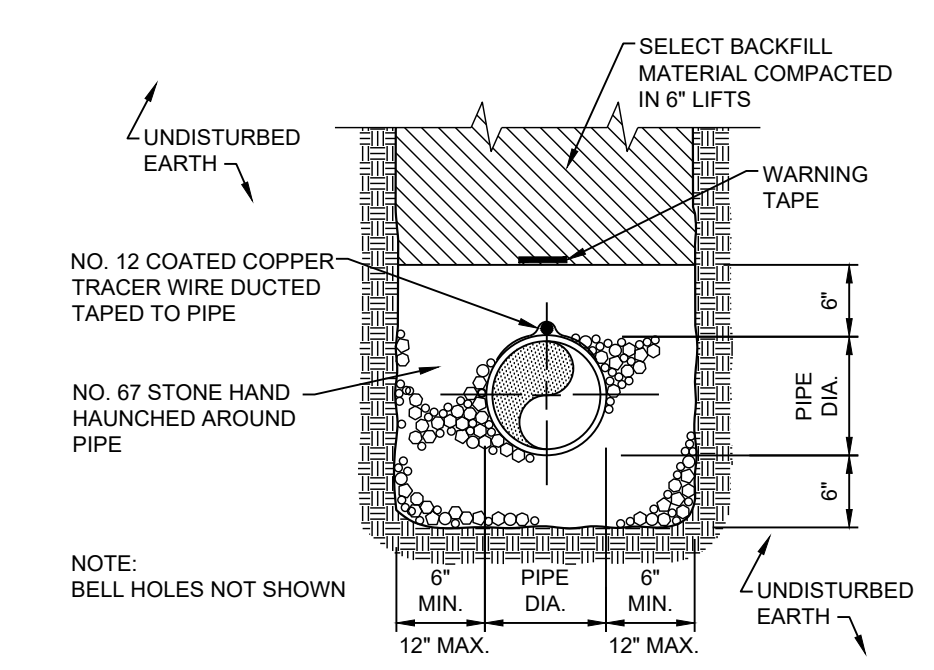

TYPICAL SEWER FORCE MAIN TRENCHING DETAIL
NOT TO SCALE

NOTE:
BELL HOLES NOT SHOWN.

CONSTRUCTION OF TRENCHES SHALL COMPLY WITH ALL FEDERAL, STATE AND LOCAL SAFETY AND HEALTH REGULATIONS WHICH HAVE JURISDICTION AT THE PROJECT SITE. IT IS THE CONTRACTOR'S RESPONSIBILITY TO BE FAMILIAR WITH THE APPLICABLE REGULATIONS AND FOLLOW THEM ACCORDINGLY.



DETAILS
FOR
SOUTHERN FORCE MAIN
THE CITY OF WHITE HOUSE
SAGE RD.
WHITE HOUSE, TN 37188
ROBERTSON COUNTY

NO.	DATE	BY	DESCRIPTION

DESIGNER **KLO**
REVIEWER **PLC**

PROJECT **21-902**

DATE **3/24/2022**

SHEET **C-501**

